

# Concept

## DRY DISPLAY CASE – GLASS ENDS – PDG

MODELS: PDG 5238, PDG 5258, PDG 5276

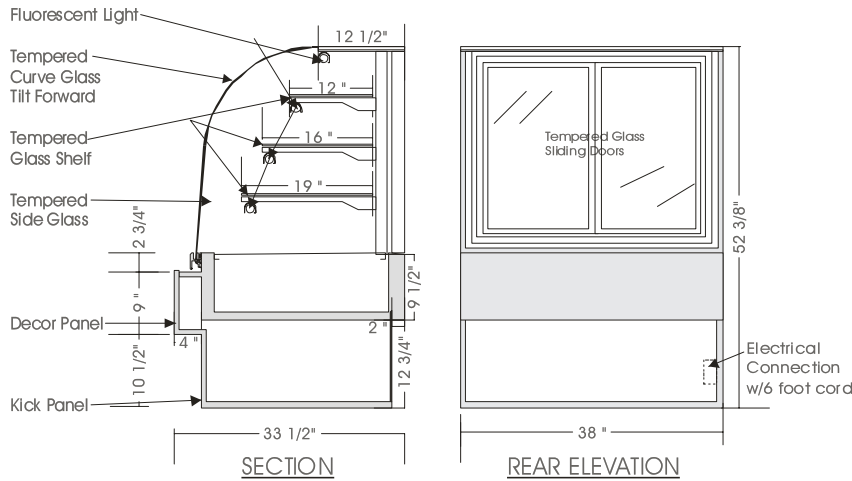

### SPECIFICATIONS

MODEL	DIMENSIONS	ELECTRICAL	SHIPPING WT.
PDG 5238	38"L.X33 1/2"D.X52 3/8"H.	115V/1/60 HZ/1.5 AMP	350 lbs.
PDG 5258	58"L.X33 1/2"D.X52 3/8"H.	115V/1/60 HZ/2.0 AMP	610 lbs.
PDG 5276	76"L.X33 1/2"D.X52 3/8"H.	115V/1/60 HZ/2.5 AMP	550 lbs

#### STANDARD FEATURES

1. Top light and shelf lights.
2. Tempered curved front glass, tilt forward & removable.
3. White epoxy coated wire shelves.
4. Front glass defogging system.
5. Clear satin anodized aluminum hinge and framework.
6. Exterior & interior laminate finish: Black.

#### OPTIONS

1. Plastic laminate exterior finish of choice.
2. Powder coated or colour anodized hinge.
3. Custom units on request.
4. Remote condensing unit.
5. Tempered glass shelves.
6. Laminate covered side gables.

\*Due to constant improvements, specifications are subject to change without notice.



## Canadian Display Systems Inc.

177 Westcreek Drive, Woodbridge, Ontario L4L 9N6  
 Ph: 905-265-7888, 1-800-895-5862 Fax: 905-265-7692  
 email [cds1@on.aibn.com](mailto:cds1@on.aibn.com)  
[www.canadiandisplayystems.com](http://www.canadiandisplayystems.com)