

Concept

REF. SELF SERVE OPEN CASE – PRSM

MODELS: PRSM 5240, PRSM 5260, PRSM 5278

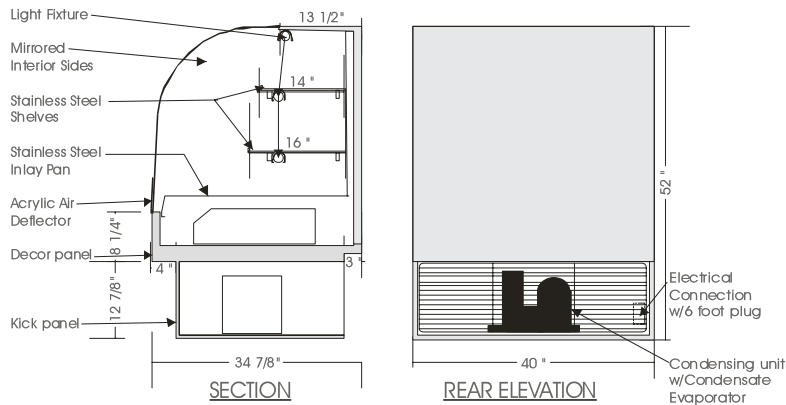

SPECIFICATIONS

MODEL	DIMENSIONS	UNIT	ELECTRICAL (DUAL VOLTAGE 1 Ph/60Hz)			SHIPPING
			H.P.	COND. UNIT	LIGHTS	
PRSM 5240	40"L.X34 $\frac{7}{8}$ "D.X52"H.	$\frac{1}{2}$	115V/16.0 AMP	115V/1.5 AMPS	115V/8.3 AMPS	380 lb.
PRSM 5260**	60"L.X34 $\frac{7}{8}$ "D.X52"H.	$\frac{3}{4}$	230V/ 9.4 AMP	115V/2.0 AMPS	115V/8.3 AMPS	550 lb.
PRSM 5278**	78"L.X34 $\frac{7}{8}$ "D.X52"H.	1	230V/12.4 AMP	115V/3.0 AMPS	115V/8.3 AMPS	800 lb.

230V Units – Permanent connection to Condensing unit, Light & Evaporator pan (Optional) supplied with cord & plug

Floor drain highly recommended for these units. Front air intake ventilation grill.

STANDARD FEATURES

1. Top light.
2. Shelf lights.
3. Solid sides w/mirrored interior gables.
4. Exterior & interior laminate finish: Black.
5. Self contained condensing unit.

OPTIONS

1. Plastic laminate exterior finish of choice
2. Custom units upon request.
3. Tempered glass shelves.
4. Remote condensing unit.
5. Mirrored sliding doors.
6. Condensate evaporator pan.

Operating temperature of 2° to 4° Celsius (37° to 40°F.) under normal store conditions of 24° Celsius (75°F.) with 50% relative humidity. Condensation may occur under hot & humid conditions.

Product entering the display case must be 4° Celsius (40°F.) or lower.

***Due to constant improvements, specifications are subject to change without notice.**

****Permanent electrical connection for these Models. 115V/1/60/8.3A for condensate evaporator pan if used. Floor drain recommended.**



Canadian Display Systems Inc.

177 West Creek Drive, Woodbridge, Ontario L4L 9N6
 Ph: 905-265-7888, 1-800-895-5862 Fax: 905-265-7692
 email [cgs1@on.aibn.com](mailto:cds1@on.aibn.com)
www.canadiandisplayystems.com