

PROJECT:

QUANTITY:

ITEM: NO:

Eurostyle

REFRIGERATED DRAWER CASE – RPD

MODELS: RPD 5338, RPD 5346, RPD 5358, RPD 5376, RPD 5392

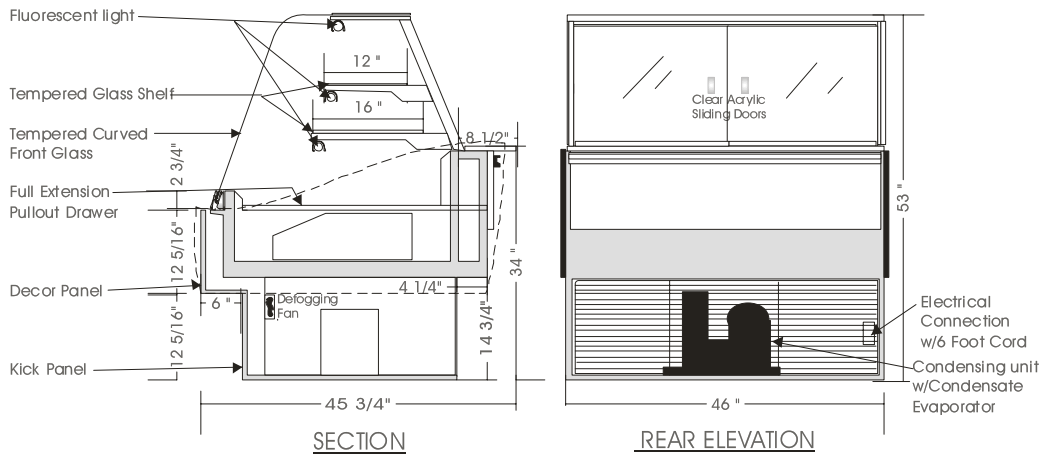

SPECIFICATIONS

MODEL	DIMENSIONS	COMPRESSOR	ELECTRICAL	SHIPPING WT.
RPD 5338	38"L.X45 $\frac{3}{4}$ "D.X53"H.	$\frac{1}{3}$ H.P.	115V/1/60HZ/10.0 AMP	525
RPD 5346	46"L.X45 $\frac{3}{4}$ "D.X53"H.	$\frac{1}{2}$ H.P.	115V/1/60HZ/12.0 AMP	650
RPD 5358	58"L.X45 $\frac{3}{4}$ "D.X53"H.	$\frac{1}{2}$ H.P.	115V/1/60HZ/12.0 AMP	700
RPD 5376	76"L.X45 $\frac{3}{4}$ "D.X53"H.	$\frac{1}{2}$ H.P.	115V/1/60HZ/13.0 AMP	800
RPD 5392**	92"L.X45 $\frac{3}{4}$ "D.X53"H.	$\frac{3}{4}$ H.P.	115V/1/60HZ/16.0 AMP	875

Note: Add $\frac{3}{4}$ " each side for side gables.

STANDARD FEATURES

1. Top light.
2. Shelf lights.
3. Tempered curved front glass, tilt forward & removable.
4. Full extension pullout laminated drawer.
5. Clear satin anodized aluminum hinge & framework.
6. Exterior & interior laminate finish: Black.
7. Laminate covered side gables.
8. Front glass defogging system.
9. Self contained compressor w/hot gas condensate evaporator pan.

OPTIONS

1. Plastic laminate exterior finish of choice.
2. Powder coated aluminum hinge and framework.
3. Custom anodized colour hinge and framework.
4. Custom units on request.
5. Remote condensing unit.

Operating temperature of 2° to 4° Celsius (37° to 40° F.) under normal store conditions of 24° Celsius (75° F.) with 50% relative humidity.

Condensation on glass may occur under hot & humid conditions.

Product entering the display case must be 4° Celsius (40° F.) or lower.

*Due to constant improvements, specifications are subject to change without notice.

** Direct electrical connection for Model RPD 5392.



Canadian Display Systems Inc.

177 West Creek Drive, Woodbridge, Ontario L4L 9N6
Ph: 905-265-7888, 1-800-895-5862 Fax: 905-265-7692

email cds1@on.aibn.com

www.canadiandisplayssystem.com