

PROJECT:

QUANTITY:

ITEM: NO:

Infinity

REFRIGERATED DISPLAY CASE – IRP

MODELS: IRP 5538, IRP 5546, IRP 5558, IRP 5576, IRP 5592

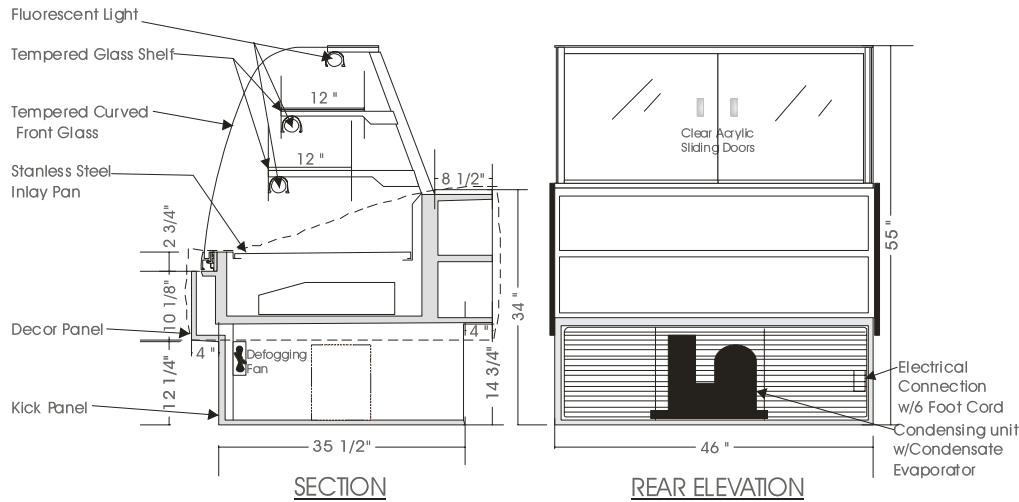

SPECIFICATIONS

MODEL	DIMENSION	COMPRESSOR	ELECTRICAL	SHIPPING WT.
IRP 5538	38"L.X44"D.X55"H.	1/3 H.P.	115V/1/60 HZ/ 9.0 AMP	525 lb.
IRP 5546	46"L.X44"D.X55"H.	1/3 H.P.	115V/1/60 HZ/10.0 AMP	650 lb.
IRP 5558	58"L.X44"D.X55"H.	1/2 H.P.	115V/1/60HZ/12.0 AMP	710 lb.
IRP 5576	76"L.X44"D.X55"H.	1/2 H.P.	115V/1/60HZ/13.0 AMP	800 lb.
IRP 5592**	92"L.X44"D.X55"H.	3/4 H.P.	115V/1/60HZ/16.0 AMP	1,050 lb.

Note: Add 3/4" each side for side gables.

STANDARD FEATURES

1. Top and shelf lights.
2. Front glass defogging system.
3. Tempered curved front glass, tilt forward and removable.
4. Stainless steel interior.
5. Clear satin anodized aluminum hinge and framework.
6. Exterior & interior laminate finish: Black.
7. Self contained air cooled compressor w/ hot gas condensate evaporator pan.
8. Laminate covered side gables.

OPTIONS

1. Plastic laminate exterior finish of choice.
2. Powder coated aluminum hinge and framework.
3. Custom anodized colour hinge and framework.
4. Extra shelf c/w light.
5. Remote condensing unit.

Operating temperature of 2° to 4° Celsius (37° to 40° F.) under normal store conditions of 24° Celsius (75° F.) with 50% relative humidity.

Condensation on glass may occur under hot & humid conditions.

Product entering the display case must be 4° Celsius (40° F.) or lower.

*Due to constant improvements, specifications are subject to change without notice.

**Permanent electrical connection for Model IRP 5592.



Canadian Display Systems Inc.

177 Westcreek Drive, Woodbridge, Ontario L4L 9N6
Ph: 905-265-7888, 1-800-895-5862 Fax: 905-265-7692

email [cgs1@on.aibn.com](mailto:cds1@on.aibn.com)
www.canadiandisplayssystems.com