

Infinity

HOT FOOD TABLE – IHD

MODELS: IHD 5538, IHD 5546, IHD 5558, IHD 5576, IHD 5592

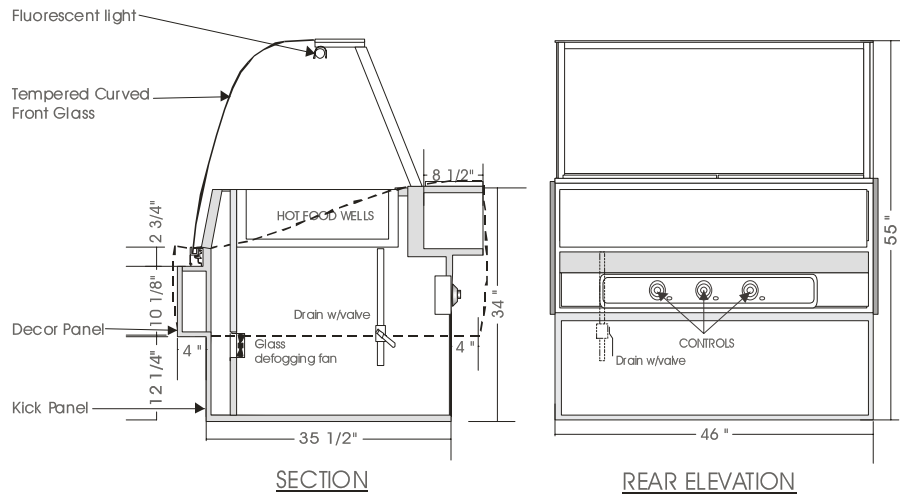

SPECIFICATIONS

| MODEL | DIMENSIONS | WELLS | ELECTRICAL (WELLS) | ELECTRICAL (LIGHT/FAN) | SHIPPING WT. |
|----------|-------------------|---------|----------------------|------------------------|--------------|
| IHD 5538 | 38"L.X44"D.X55"H. | 2 WELLS | 208V/1/60HZ/11.9 Amp | 115V/1/60HZ/1.5 Amp | 360 lb. |
| IHD 5546 | 46"L.X44"D.X55"H. | 3 WELLS | 208V/1/60HZ/17.9 Amp | 115V/1/60HZ/1.8 Amp | 460 lb. |
| IHD 5558 | 58"L.X44"D.X55"H. | 4 WELLS | 208V/1/60HZ/23.8 Amp | 115V/1/60HZ/2.0 Amp | 530 lb. |
| IHD 5576 | 76"L.X44"D.X55"H. | 5 WELLS | 208V/1/60HZ/29.8 Amp | 115V/1/60HZ/2.5 Amp | 650 lb. |
| IHD 5592 | 92"L.X44"D.X55"H. | 6 WELLS | 208V/1/60HZ/35.8 Amp | 115V/1/60HZ/3.0 Amp | 890 lb. |

Note: Add 3/4" each side for side gables.

STANDARD FEATURES

1. Top light.
2. Sani board work surface.
3. Tempered tilt forward glass front, removable.
4. Tempered glass side, removable.
5. Stainless steel interior.
6. Clear satin anodized aluminum hinge and framework.
7. Exterior & interior laminate finish: Black.
8. Laminate covered side gables.

OPTIONS

1. Plastic laminate exterior finish of choice.
2. Powder coated aluminum hinge and framework.
3. Custom anodized colour hinge and framework.
4. Custom units on request.
5. Additional glass shelves w/lights.

*Due to constant improvements, specifications are subject to change without notice.



Canadian Display Systems Inc.

177 Westcreek Drive, Woodbridge, Ontario L4L 9N6
Ph: 905-265-7888, 1-800-895-5862 Fax: 905-265-7692

email cds1@on.aibn.com

www.canadiandisplayystems.com