

Signature

REFRIGERATED DRAWER DISPLAY – DLRP-D

MODELS: DLRP-D 5138, DLRP-D 5146, DLRP-D 5158, DLRP-D 5176, DLRP-D 5192

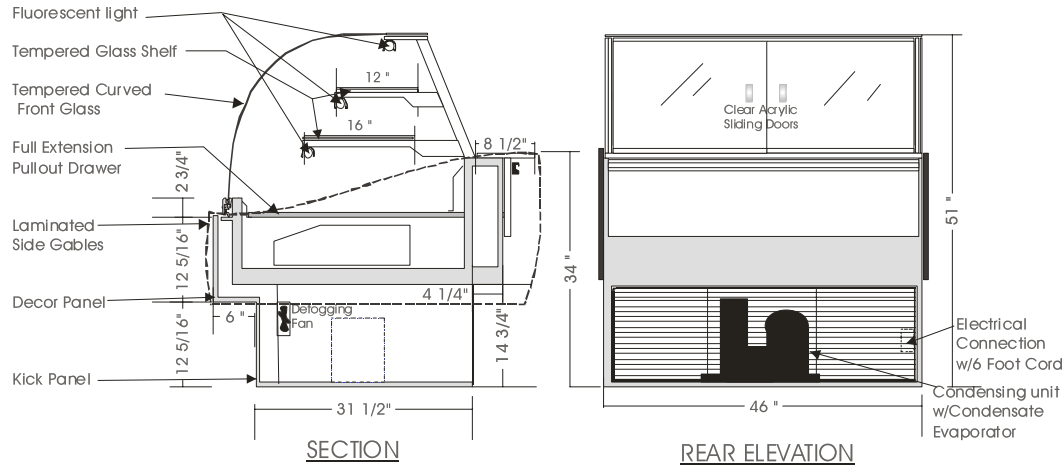

SPECIFICATIONS

MODEL	DIMENSIONS	COMPRESSOR	ELECTRICAL	SHIPPING WT.
DLRP-D 5138	38"L.X45 ³ / ₄ "D.X51"H.	1/3 H.P.	115V/1/60 HZ/10.0 AMP	525 lb.
DLRP-D 5146	46"L.X45 ³ / ₄ "D.X51"H.	1/2 H.P.	115V/1/60 HZ/11.5 AMP	650 lb.
DLRP-D 5158	58"L.X45 ³ / ₄ "D.X51"H.	1/2 H.P.	115V/1/60 HZ/12.0 AMP	710 lb.
DLRP-D 5176	76"L.X45 ³ / ₄ "D.X51"H.	1/2 H.P.	115V/1/60 HZ/13.0 AMP	800 lb.
DLRP-D 5192**	92"L.X45 ³ / ₄ "D.X51"H.	3/4 H.P.	115V/1/60 HZ/16.0 AMP	1,050 lb.

Note: Add 3/4" each side for side gables.

STANDARD FEATURES

1. Top light.
2. Shelf lights.
3. Tempered curved front glass – tilt forward and removable.
4. Front glass defogging system.
5. Laminated full extension pullout drawers.
6. Stainless steel interior.
7. Clear satin anodized aluminum hinge and framework.
8. Self contained air cooled compressor w/hot gas condensate evaporator pan.
9. Exterior & interior laminate finish: Black.
10. Laminate covered side gables.

OPTIONS

1. Plastic laminate exterior finish of choice.
2. Powder coated aluminum hinge and framework.
3. Custom anodized colour hinge and framework.
4. Custom units on request.
5. Remote condensing unit.

Operating temperature of 2° to 4° Celsius (37° to 40°F.) under normal store conditions of 24° Celsius (75°F.) with 50% relative humidity. Condensation on glass may occur under hot & humid conditions.

Product entering the display case must be 4° Celsius (40°F.) or lower.

*Due to constant improvements, specifications are subject to change without notice.

** Permanent electrical connection required.



Canadian Display Systems Inc.

177 Westcreek Drive, Woodbridge, Ontario L4L 9N6
 Ph: 905-265-7888, 1-800-895-5862 Fax: 905-265-7692
 email cds1@on.aibn.com
www.canadiandisplayystems.com