

Signature

REFRIGERATED DELI CASE – DLRD

MODELS: DLRD 5138, DLRD 5146, DLRD 5158, DLRD 5176, DLRD 5192

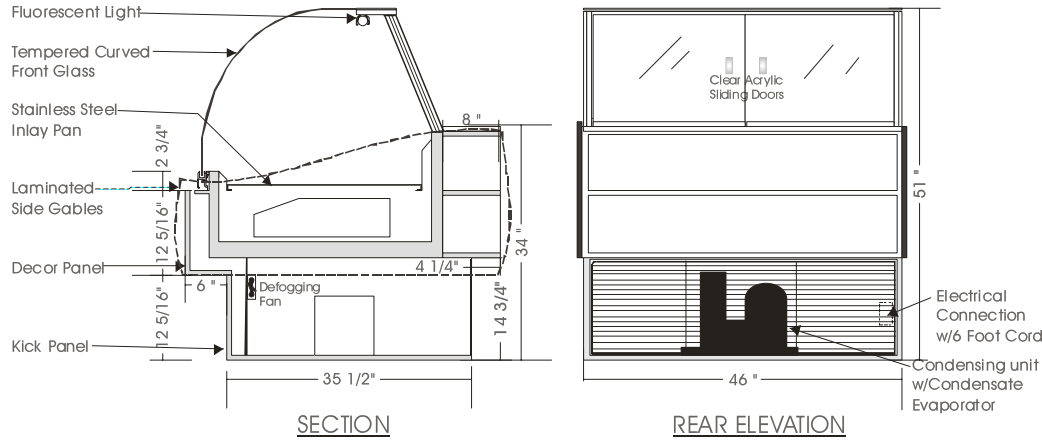

SPECIFICATIONS

MODEL	DIMENSIONS	COMPRESSOR	ELECTRICAL	SHIPPING WT.
DLRD 5138	38"L.X45 ³ / ₄ "D.X51"H.	1/3 H.P.	115V/1/60HZ/ 9.0 AMP	420 lb.
DLRD 5146	46"L.X45 ³ / ₄ "D.X51"H.	1/3 H.P.	115V/1/60HZ/10.0 AMP	480 lb.
DLRD 5158	58"L.X45 ³ / ₄ "D.X51"H.	1/2 H.P.	115V/1/60HZ/12.0 AMP	550 lb.
DLRD 5176	76"L.X45 ³ / ₄ "D.X51"H.	1/2 H.P.	115V/1/60HZ/13.0 AMP	740 lb.
DLRD 5192**	92"L.X45 ³ / ₄ "D.X51"H.	3/4 H.P.	115V/1/60HZ/16.0 AMP	825 lb.

Note: Add 3/4" each side for side gables.

STANDARD FEATURES

1. Top light.
2. Sani board work surface.
3. Tempered curved front glass, tilt forward and removable.
4. Front glass defogging system.
5. Stainless steel interior.
6. Clear satin anodized hinge and framework.
7. Interior & exterior laminate finish: Black.
8. Self contained air cooled compressor w/hot gas condensate evaporator pan.
9. Laminate covered side gables.

Operating temperature of 2° to 4° Celsius (37° to 40°F.) under normal store conditions of 24° Celsius (75°F.) with 50% relative humidity. Condensation on glass may occur under hot & humid conditions.

Product entering the display case must be 4° Celsius (40°F.) or lower.

*Due to constant improvements, specifications are subject to change without notice.

** Permanent electrical connection required

OPTIONS

1. Plastic laminate exterior finish of choice.
2. Powder coated aluminum hinge and framework.
3. Custom anodized colour hinge and framework.
4. Custom units on request.
5. Additional glass shelves w/lights.
6. Stainless steel or laminate covered steps.
7. Remote condensing unit.



Canadian Display Systems Inc.

177 Westcreek Drive, Woodbridge, Ontario L4L 9N6
 Ph: 905-265-7888, 1-800-895-5862 Fax: 905-265-7692
 email cds1@on.aibn.com
www.canadiandisplayssystems.com